

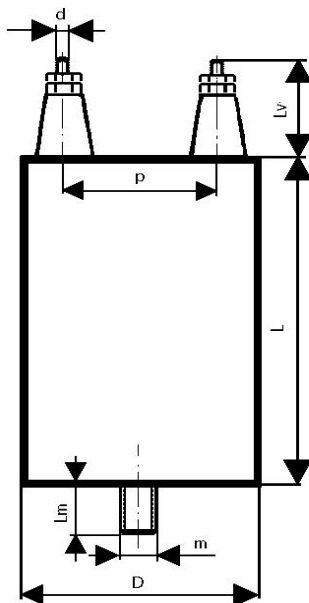

KPI 500-093 CAPACITORS FOR DC & AC APPLICATIONS

Construction L



Construction:

Metallic electrodes, polypropylene film dielectric, non-inductive, self-healing construction,
Plastic cylindrical flame retardant case
Leads are screws M6x10 on the upper face of the case. Bottom screw M8x15 for mounting.

Applications:

DC and AC applications with high pulse loading

Technical data

Rated voltage U_R : 16 000V DC

Rated voltage is the max. DC or peak voltage, for which the capacitor is designed.

If the capacitor works with the DC and also super-imposed AC voltage U_{AC} , the sum of DC and the amplitude of AC must not exceed the U_R

Max permissible AC voltage: 4000V 50/60Hz,
If the working frequency is higher, the permissible AC voltage must be decreased, not to exceed the max. loss power of the capacitor.

Rated capacitance: 50 ÷ 100nF,

other capacity on request

Tolerance: ±20%, ±10%,

Dissipation factor $Tg\delta$: < 0,0006 at 1kHz and +25°C

Operating temperature range: -40 ÷ +70°C

The highest permissible capacitor temperature at the hottest point of the case must not exceed +70°C.

Max. permitted dissipation power of the capacitor depend on the construction of the capacitor and the cooling conditions

Test voltage between terminals: 18 000VDC, 10sec. at +25°C,

All capacitors are tested by the routine test by the manufacturer

Protection against Over-voltages:

The capacitors are self-healing and regenerate themselves after occasional breakdowns. The capacitor remains fully functional after the breakdown.

Permitted Over-voltages in working conditions:

1,1 x U_R max. 10% of the service period

If the Over-voltages exceed the permissible values above, the capacitor might have been destroyed.

Test voltage between terminals and case:

18 000VDC, 1min. at +25°C

Max. repetitive rate of voltage rise dU/dt :
< 500V/µsec at U_R and +25°C

Max. peak current I_p : < $C_R \times dU/dt$

Related standards: IEC 60384-1

Marking for purchase ordering:

KPI500-093 100nF±10% 16 000V DC

Warning! The manufacturer is not responsible for any damages, caused by the improper installation and application. Before using the capacitor in any application, please, read carefully this technical data-sheet.

Capacity [nF]	Dimensions [mm]		
	D	L	p
50	50	150	50
68	63	150	50
82	75	150	50
100	75	150	50